

AVIATOR



www.AviatorTerminal.com





 AVIATOR

 AVIATOR

4130 SKYTRAIN WAY COLLEGE PARK, GA 30337
HARTSFIELD-JACKSON ATLANTA INTERNATIONAL AIRPORT (ATL)





GROUND FLOOR (Parking)





1ST FLOOR (Current Lobby & Parking) - PHASE II



PROPOSED:



FOOD & BEVERAGE



COFFEE SHOP



BAR



RETAIL

35,000 SQ. FT.

LOBBY



2nd FLOOR. - PHASE I





3rd FLOOR

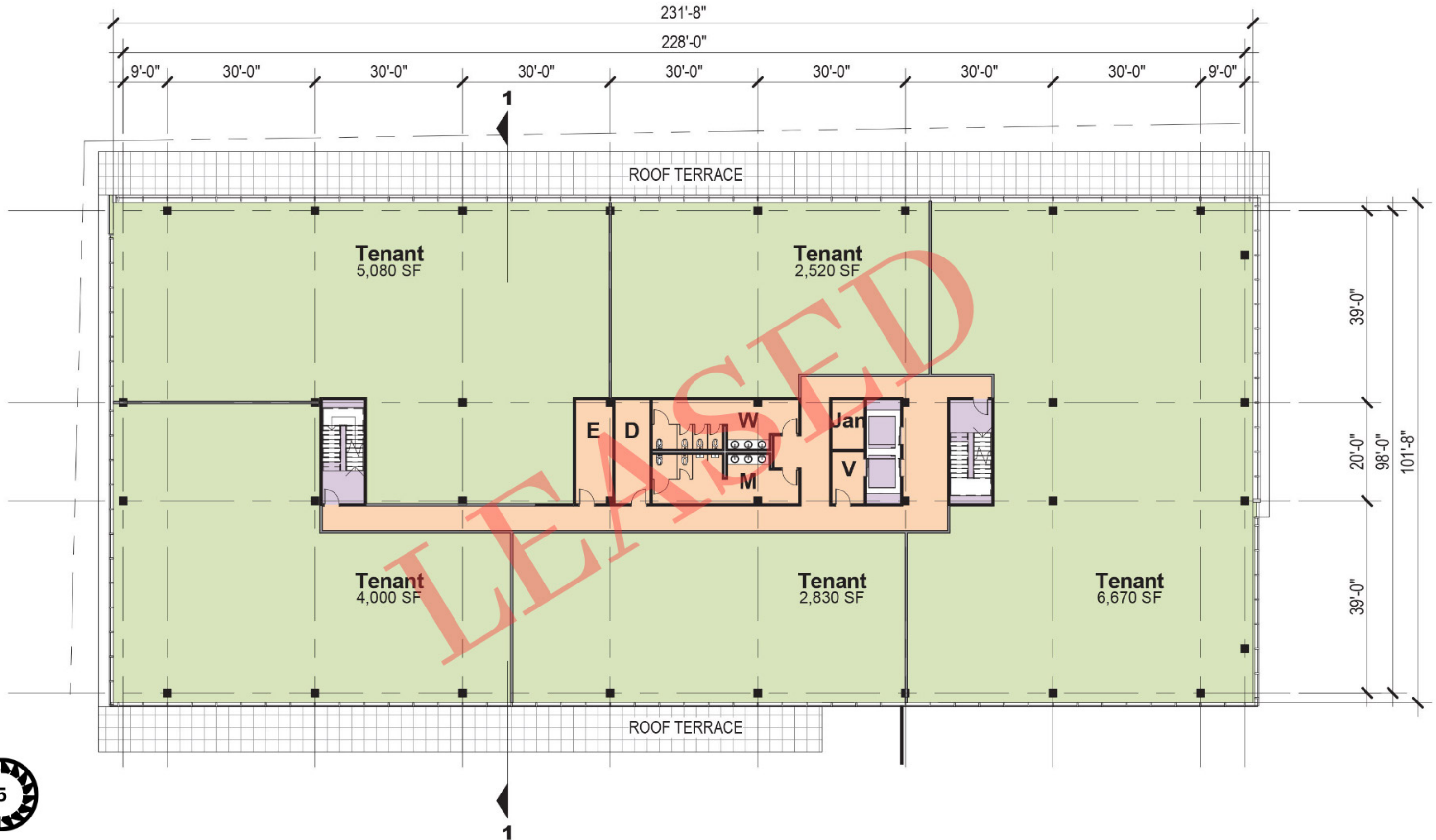



4th FLOOR - ROOF TOP - PHASE III



LOCATION



VISION



PAN AMERICAN

“The Aviator” Terminal is a third terminal experience—located just 1 minute and 50 seconds from Hartsfield-Jackson via the SkyTrain.

Unlike traditional terminals, The Aviator is designed for what travelers actually need:

Space to work

Quality food & coffee

A place to meet or reset

An elevated environment before or after your flight

NOW BOARDING



MOOD



LOBBY VIBES



SHARED / COWORKING SPACE



NAP YORK - ATL



NAP YORK

• SLEEP • SHOWER • GO • REST • DREAM • RECHARGE • MEDITATE • NAP • SLEEP •

OUR PODS



Economy Class Pod

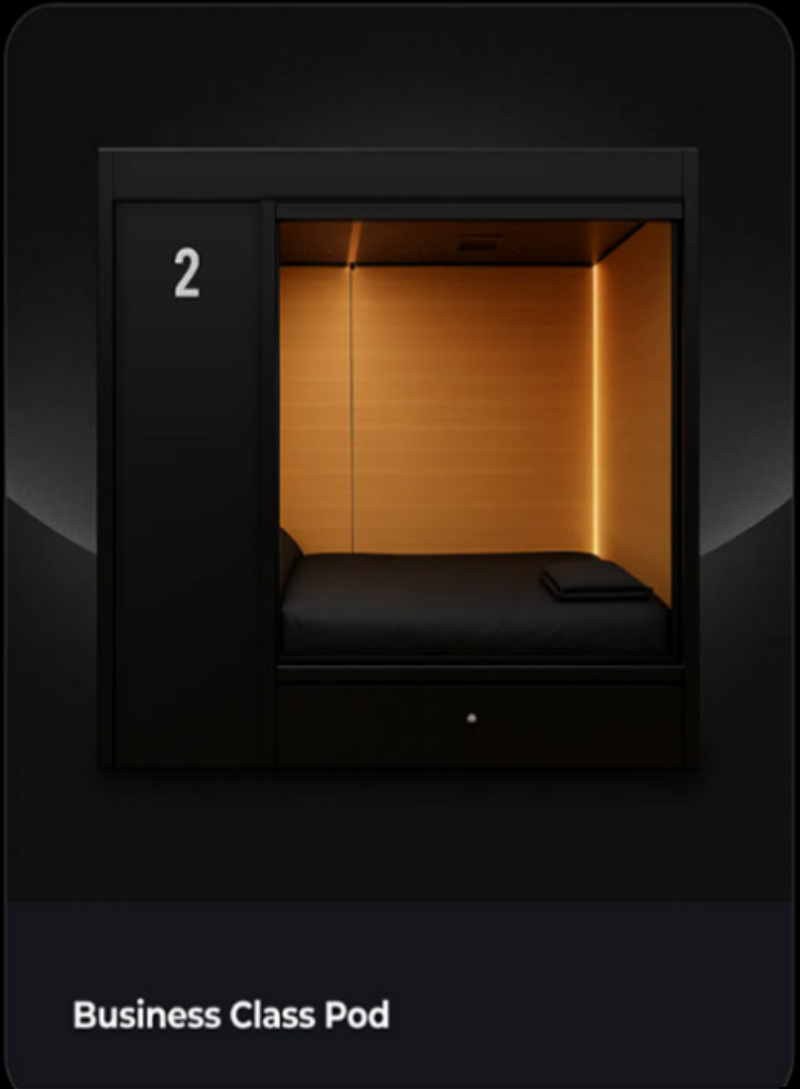

Business Class Pod

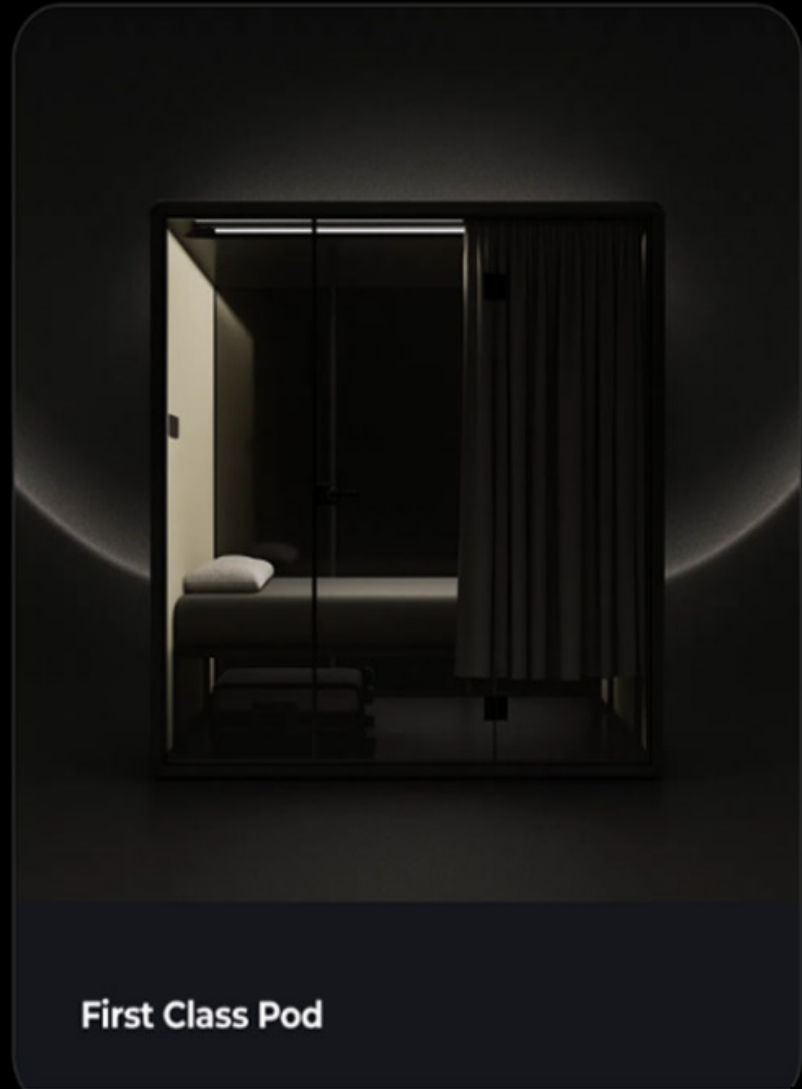

First Class Pod

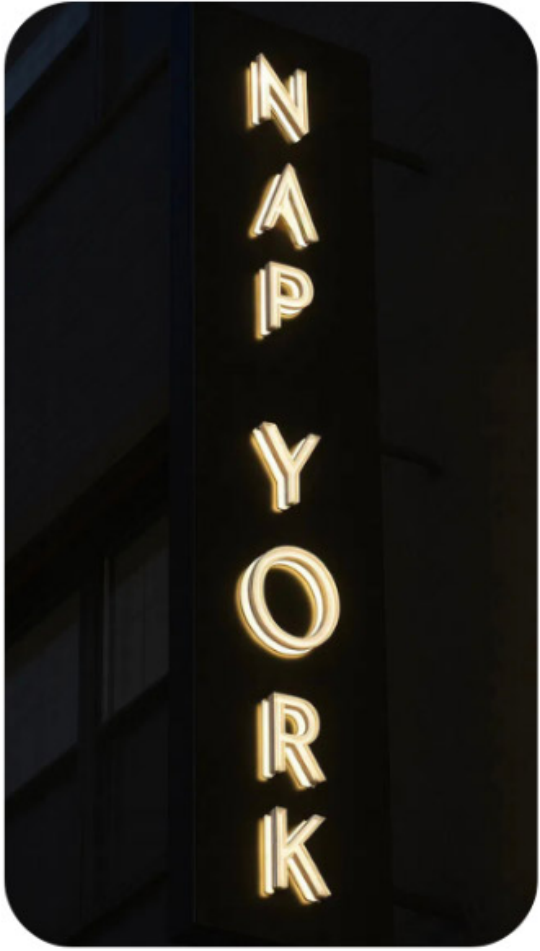

PROPER COFFEE SHOP



COFFEE

FOOD & BEVERAGE SPACES



STEAK HOUSE ANCHOR



A SPEAKEASY / BAR





DEMOGRAPHICS + MARKET PROFILE

MACRO DEMAND (GLOBAL TRAFFIC DRIVER)

- 100M+ annual passengers at Hartsfield-Jackson (world's busiest airport)
- 1,000+ daily flights to 225+ destinations
- Global traveler base (domestic + international)

**This is not local demand—this is national + international traffic flowing daily*

SKYTRAIN CONNECTIVITY (DIRECT FUNNEL) *Direct access via ATL SkyTrain (~5-minute ride)*

Connects:

- Domestic Terminal + Access to International Terminal
- Rental Car Center
- Georgia International Convention Center (GICC)
- 5,000,000+ annual SkyTrain riders

**The Aviator sits on a controlled transit corridor, capturing intentional traveler movement.*

IMMEDIATE DEMAND (WALKABLE ECOSYSTEM)

- 1,100+ hotel guests nightly within immediate area
Surrounded by 6+ hotels
- Convention + event traffic via GICC

*Captive audience with:

- Limited quality food options
- Limited workspace / lounge options
- High need for pre/post-flight experiences

SPENDING PROFILE

Tier 1 – High Value

- Business travelers
- Airline professionals
- Expense-account spending (Amex client)

Tier 2 – Volume

- Airport staff
- Budget travelers
- Service workers

*Strategy = dual pricing model (premium + accessible)

 AVIATOR

 AVIATOR



20

ATL SKYTRAIN - 5 MILLION RIDERS A YEAR









DEPARTMENT OF HOMELAND SECURITY • U.S. CUSTOMS AND BORDER PROTECTION
ADMITTED
28 JAN - 7 2006
Class Until WB
1643
APR - 7 2006





ATL SkyTrain **LEGEND**

- 1 min. 50 seconds ride from Sky Train to Airport
- The ATL SkyTrain arrives every two minutes (every 10 minutes between 11:00 pm and 4:00 am)

	SKY TRAIN		AIRPORT
	MARTA		BUILDINGS
	PARKINGS		HIGHWAY
	ATL WEST PARKING		
	• 6,000 Parking Spaces		
	ATL RENTAL CAR CENTER		

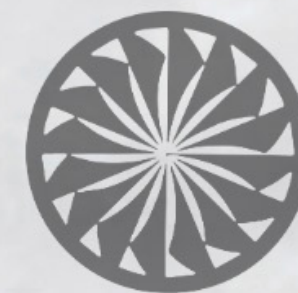

AVIATOR



4130 SKYTRAIN WAY COLLEGE PARK, GA 30337

HARTSFIELD-JACKSON ATLANTA INTERNATIONAL AIRPORT (ATL)



HOWARD HUGHES
NEW YORK WORLD'S FAIR 1939
Incorporated

~~WORLD'S FAIR, NEW YORK~~
~~PARIS, FRANCE~~
~~MOSCOW, U.S.S.R.~~
~~OMSK U.S.S.R.~~
~~YAKUTSK~~
~~FAIRBANKS, ALASKA~~
MINNEAPOLIS

NEW YORK, N. Y. ✓

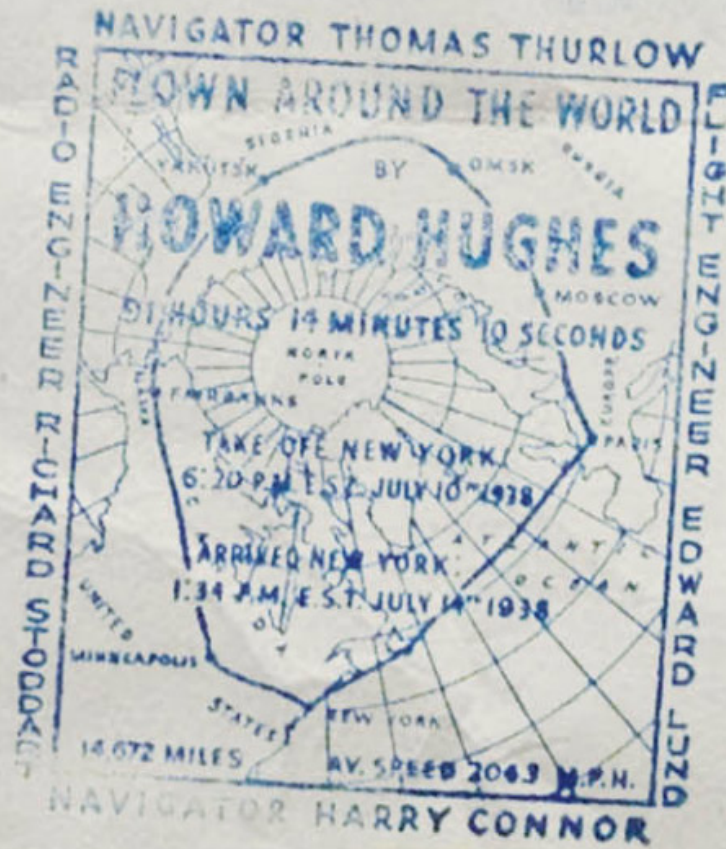

Welcome to Aviator

By air mail
Par avion

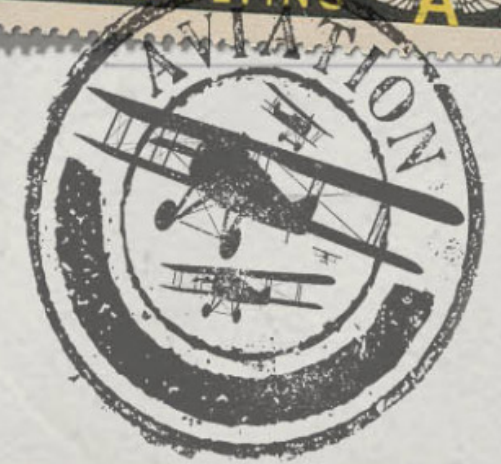

©2026 The Aviator. All rights reserved.

The Aviator name, concept, and
associated branding are the property of

Block-C Group, LLC and may not be used,

reproduced, or distributed without prior
written consent.

CONTACT

Kevin Henao

404-480-8123

kevin@blockCproperties.com

www.blockCproperties.com

BLOCK-C
P R O P E R T I E S

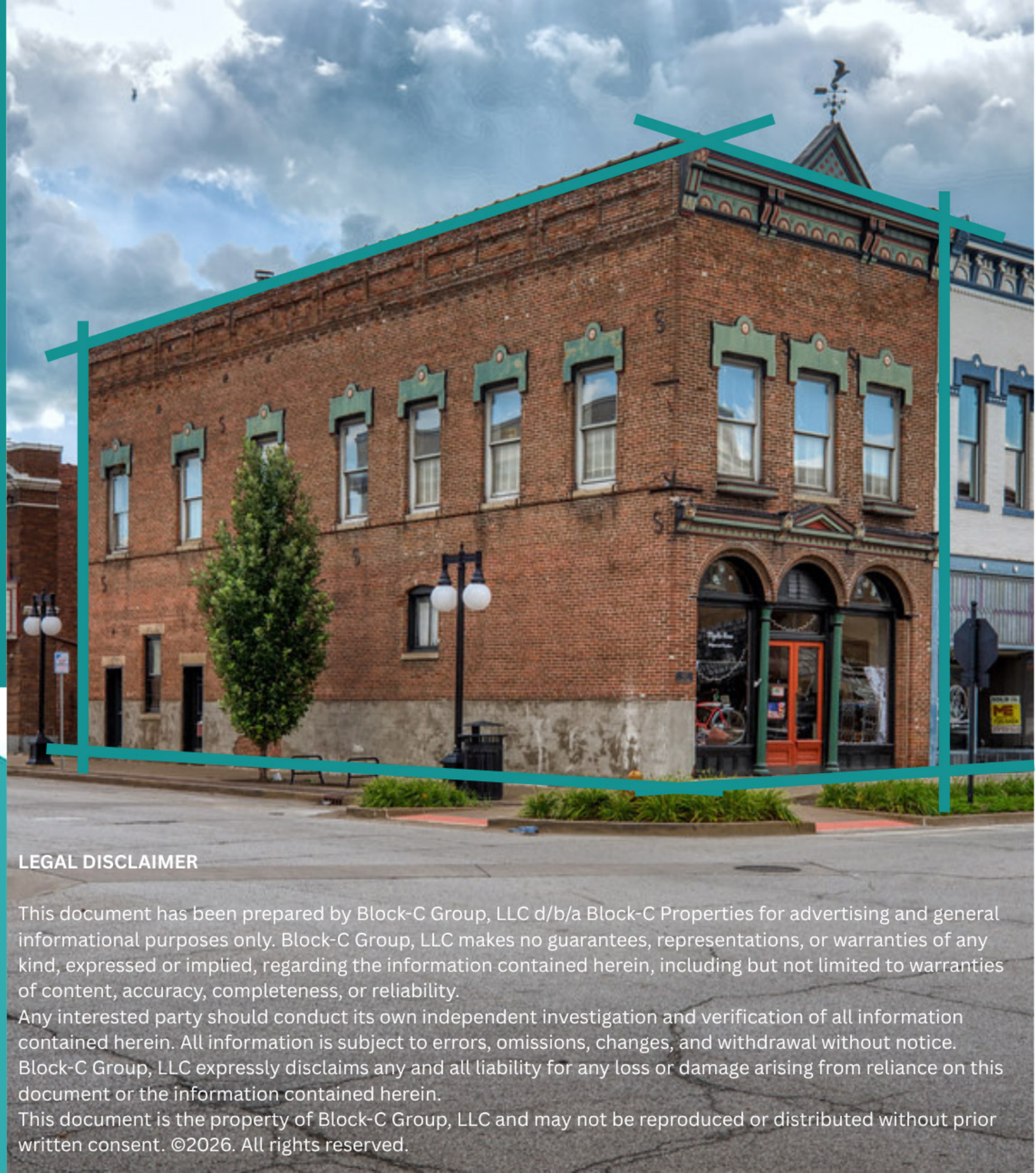

LEGAL DISCLAIMER

This document has been prepared by Block-C Group, LLC d/b/a Block-C Properties for advertising and general informational purposes only. Block-C Group, LLC makes no guarantees, representations, or warranties of any kind, expressed or implied, regarding the information contained herein, including but not limited to warranties of content, accuracy, completeness, or reliability.

Any interested party should conduct its own independent investigation and verification of all information contained herein. All information is subject to errors, omissions, changes, and withdrawal without notice. Block-C Group, LLC expressly disclaims any and all liability for any loss or damage arising from reliance on this document or the information contained herein.

This document is the property of Block-C Group, LLC and may not be reproduced or distributed without prior written consent. ©2026. All rights reserved.